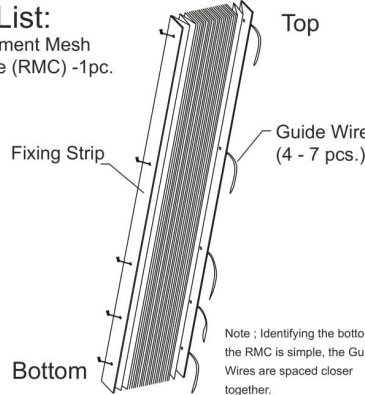
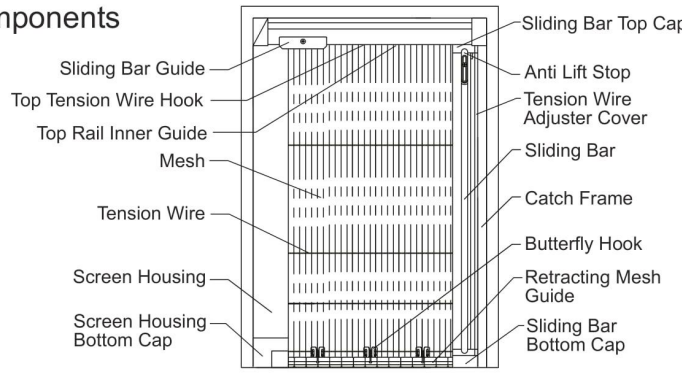

# Replacement Mesh Cartridge (RMC) (Retractable Screen)

## Installation Manual

**Orientation:** The Mesh/Screen "Opened" describes the unit in it's retracted position.  
The Mesh/Screen "Closed" describes the unit in it's drawn position.

<p><b>Part List:</b> Replacement Mesh Cartridge (RMC) -1pc.</p> 	<p><b>Components</b></p> 
---	---

## Remove Damaged RMC

### Step #1 Remove the Screen Housing Assembly

Note ; Before replacing the RMC the Screen Housing Assembly must be removed from the door frame.

1. Close the screen/s, remove the Tension Wire from the Hook through the slit on the hook. Slide each Hook to the Slot in the Inner Guide and remove them by turning them 90 degrees and pull away from the Guide.

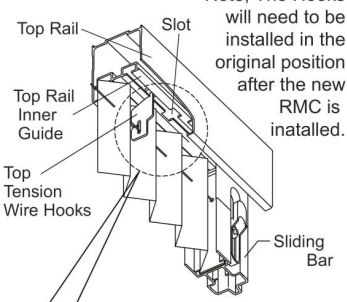

2. Loosen screw on the Anti Lift Stop. Slide it downward.

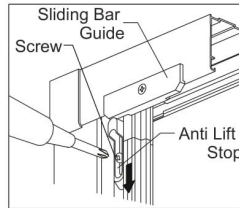

3. Single Screen: Remove the Catch Frame by removing the screws.

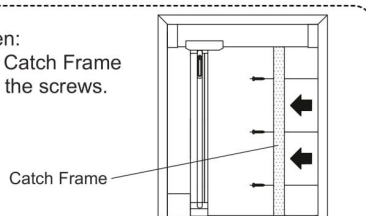

- Double Screen: Remove the Roller Piece by removing the screw in the center of the Inner Guide Connector.

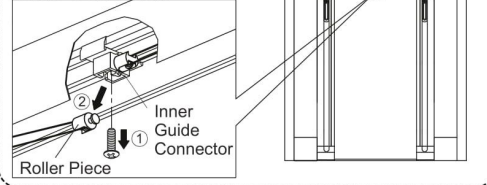

4. Remove the Screen Housing from the Mounting Bracket. Squeeze the open end (1) of the Housing and push (2) to snap it from the Mounting Bracket.

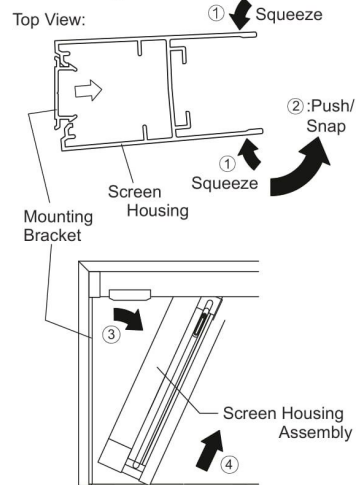

Tilt the top of the Screen Housing Assembly (3) and lift it up (4) to remove it from the door frame as in the illustration above.

### Step #2 Remove the Tension Wire Adjuster Covers and Magnets/Magnet Catches

1. Insert a flat head screw driver into the notch on the top of the Sliding Bar and twist the driver to pop off the top Tension Wire Adjuster Cover.

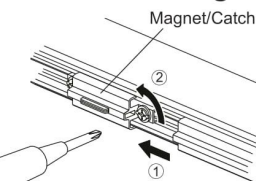
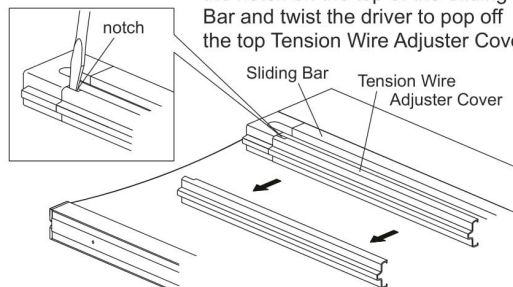

2. Slide the Magnet(s)/Catch(s) (1) so that both locking screws are visible. Turn the locking screws 90°, this will release the Magnet(s)/Catch(s) from the Sliding Bar.

3. Remove the other Tension Wire Adjuster Cover(s) using a screw driver as illustrated below.

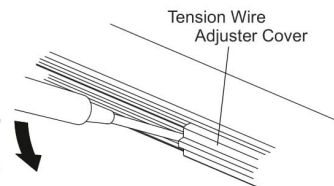

## ■ Removing the Damaged RMC

### Step #3 Remove the Butterfly Hooks and Mesh

**Note:** This Step requires the unit to be laid on a flat surface.

1. Close the unit, then remove the Clips using flat head screw driver. The Clips are like a spring and may hurdle from their position, while removing them cup them with other hand when removing.

Note; The Clips are located on the inside of both the Sliding Bar and the Screen Housing.

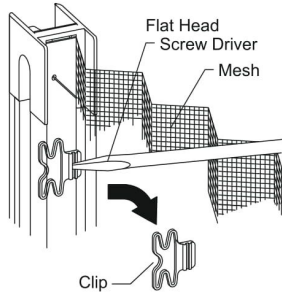

2. Remove the Tension Wire from the Butterfly Hooks then the Hooks from the Retracting Mesh Guide. (1)
3. Remove the Fixing Strips (2) from the Screen Housing and Sliding Bar, to do so, pull the mesh at the top closest to the Strip to free it from the recess in the extrusion. Continue pulling one edge of the Strip until it is completely removed.

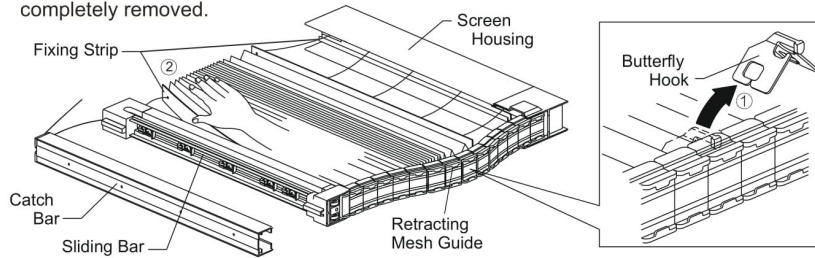

4. Remove the knotted wires from the Tension Wire Adjusters. (3)
5. Pull the wires out from the Sliding Bar and the Mesh. (4)

Note; For the installation of the new RMC, it is important it be installed in the same "Top and Bottom" orientation for aligning the wires with the holes in the mesh and Sliding Bar. The bottom has more wires at a closer pitch than the top.

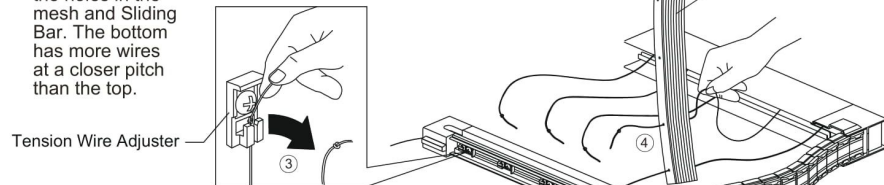

**Attention; DO NOT** remove the unified group of wires below the top adjuster on the Sliding Bar.  
**Attention; DO NOT** move the Tension Wire Adjusters by loosening the screws.  
**Attention; DO NOT** remove the wires from the Screen Housing.

## ■ Installing the new RMC

### Step #4 Setting of the Wires

**Attention;** Be sure to install the new RMC in proper Top/Bottom orientation. The bottom is easily differentiated as the Guide Wires are at a closer pitch than those at the top.

1. Begin with the top Tension Wire originating from the Screen Housing. Insert the wire through the loop in the Guide Wire.

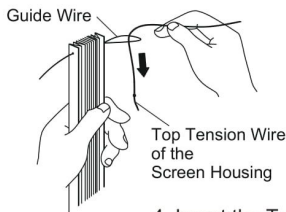

2. While holding the end of the Tension Wire, pull the Guide Wire through the RMC as illustrated below.

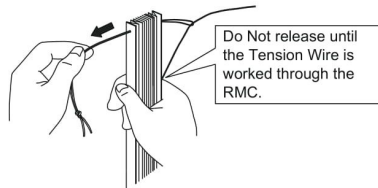

Do Not release until the Tension Wire is worked through the RMC.

3. Repeat the previous procedures with the remaining Tension Wires.

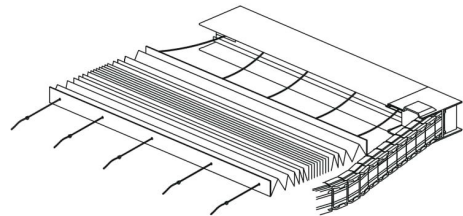

4. Insert the Tension Wires in through the corresponding holes on the Sliding Bar working from the top, towards the bottom. (1) Note; The top and bottom Tension Wires must be fed through the Sliding Bar's Top and Bottom Caps, as illustrated below (3) & (4).

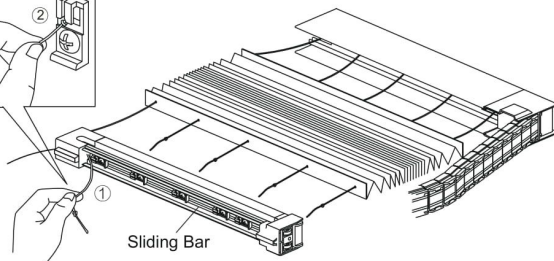
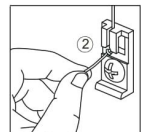

5. Fit the knot on the end of the Tension Wires onto the Tension Wire Adjuster. (2) All Wires install on the Adjusters with the knot on the bottom, and the Wire leading towards the top, only the bottom wire is fitted in the reverse.

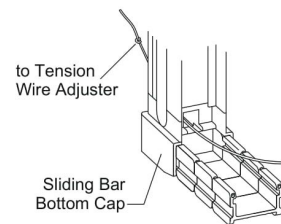
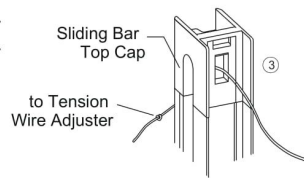

### Step #5 Reinstall the Screen Housing

1. In reverse order of Step #2 and #3, reinstall the Tension Wire Adjuster Covers, Magnet(s)/Catch(s), Fixing Strips, Clips, Butterfly Hooks and Top Tension Wire Hooks.
2. Reinstall the Screen Housing Assembly onto the door frame in reverse order of Step #1.